

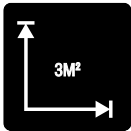

## PLASTIC PRIMER



**THEORETICAL COVERAGE**



**STRONG BOND**



**FLEXIBLE**



**QUICK DRYING**



**CLEAN**



**3 MIN SHAKE**



**25 CM SPRAY DISTANCE**



**SPRAY PATTERN**



**5 MIN TIME BETWEEN LAYERS**

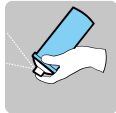

**CLEAN UP**



**5 MIN TOUCH DRY**



**ALL PAINTS OVERPAINT**



**PLASTIC PRIMER SOLVENT BASED**

Car-Rep® Transparent Plastic Primer is especially developed for plastic surfaces, but improves adhesion of paint and lacquer topcoats to all surfaces, including chrome. Due to strong adhesion the primer can be applied to hard-plastic parts of vehicles or any other objects for interior and exterior use.

Applicable for following hard plastics: ABS (acrylic butadiene styrene plastics), EPDM (polypropylene rubber, modified), Hard PVC (hard polyvinyl chloride), Glass-fiber and glass-fiber reinforced plastics, PA (polyamide), PUR (polyurethane), PS (polystyrene). Before priming check the suitability of the primer on a small surface area.

Primer could be painted over with any Car-Rep® aerosol paint.

**BINDER:** Other

**STORAGE STABILITY:** 60 months

**SIZE:** 400ml

**SALES QTY:**  
400ml: 6 pcs

**USAGE INSTRUCTIONS:**

When using the product indoors, ensure that the area within at least a 5-meter radius of the painted object is protected. Paint dust is lightweight and can spread over long distances through ventilation.

## CAR-REP Plastic Primer

Art. No.	CAR-REP Plastic Primer	Color	Barcode
CR01072	Spray Car-Rep Plastic Primer 400ml		6412490024512